

T-Slot and Advant-Edge Clamps



The original MITEE-BITE T-Slot Clamp combines our unique cam action clamping element with a T-nut.



- ▶ Locks in machine T-slot for low profile clamping
- ▶ Makes fast set-ups possible right on the machine table
- ▶ Brass hex follows contour of unusual shaped parts
- ▶ Packaged in pairs or complete kits

MITEE-BITE T-SLOT KITS (Contents: 4 Mitee-Bite T-Nuts, 6 Mitee-Bite Fixture Clamps, 2 Hex Keys)

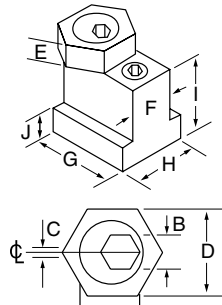

Part Number	Cam Screw	T-Slot Size	B	C	D	E	F	G	H	I	J	Max. Torque (Ft/Lbs)	Holding Force (Lbs)	Replacement		
														Cam Screw	Hex Washer	T-Nut
INCH																
10640	1/4-20	3/8	1/8	.040	.625	.190	.365	.89	.500	.375	.150	6.2	800	10365	10582	10714
10641	5/16-18	7/16	3/16	.040	.812	.190	.425	1.10	.625	.625	.220	8.3	800	10367	10584	10715
10642	3/8-16	1/2	3/16	.050	.812	.250	.490	1.20	.750	.625	.235	20.8	2,000	10371	10586	10716
10643	3/8-16	9/16	3/16	.050	.812	.250	.550	1.20	.875	.750	.300	20.8	2,000	10371	10586	10717
10644	1/2-13	5/8	5/16	.100	1.000	.375	.620	1.27	1.000	.875	.425	45.0	3,000	10373	10588	10718
10646	1/2-13	11/16	5/16	.100	1.000	.375	.675	1.37	1.000	1.000	.350	45.0	3,000	10373	10588	10719

Part Number	Cam Screw	T-Slot Size	B	C	D	E	F	G	H	I	J	Max. Holding Torque (N.m)	Holding Force (N)	Replacement		
														Cam Screw	Hex Washer	T-Nut
METRIC																
50642	M6 x 1.00	8mm	5mm	1.01	15.86	4.75	8	23.2	12.7	9.5	4.6	8.55	3,558	50365	10582	50708
50644	M6 x 1.00	10mm	5mm	1.01	15.86	4.75	10	23.2	14.2	14.2	4.3	8.55	3,558	50365	10582	50710
50646	M8 x 1.25	12mm	5mm	1.01	20.62	4.75	12	27.9	15.9	15.9	6.4	11.30	3,355	50367	10584	50712
50648	M10 x 1.50	14mm	7mm	1.52	20.62	6.35	14	30.5	22.4	22.2	8.5	28.00	8,895	50369	10586	50714
50650	M12 x 1.75	16mm	8mm	2.03	25.40	9.53	16	30.9	25.4	22.2	9.2	61.00	13,340	50371	10590	50716
50652	M12 x 1.75	18mm	8mm	2.03	25.40	9.53	18	34.7	28.6	28.6	10.5	61.00	13,340	50371	10590	50718
50654	M16 x 2.00	20mm	12mm	2.54	30.15	12.70	20	39.2	31.8	31.8	12.6	135.00	26,680	50373	10592	50720
50656	M16 x 2.00	22mm	12mm	2.54	30.15	12.70	22	44.3	34.9	41.3	12.5	135.00	26,680	50373	10592	50722

T-SLOT CLAMPS



	Part Number	T-Slot Size	Number of Clamps Per Pack	Holding Force (Lbs)		Part Number	T-Slot Size	Number of Clamps Per Pack	Holding Force (N)
INCH	10420	3/8	2	800	METRIC	50422	8mm	2	3,558
	10421	7/16	2	800		50424	10mm	2	3,558
	10422	1/2	2	2,000		50426	12mm	2	3,355
	10423	9/16	2	2,000		50428	14mm	2	8,895
	10424	5/8	2	3,000		50430	16mm	2	13,340
	10426	11/16	2	3,000		50432	18mm	2	13,340
						50434	20mm	2	26,680
						50436	22mm	2	26,680

Hex key not included.

ADVANT-EDGE CLAMPS

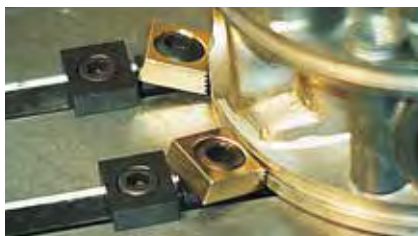

The MITEE-BITE Advant-Edge Clamp provides additional clamping force and improved table grip.

- ▶ Tilted clamping element creates a positive downward force and 4,000 lbs. holding force
- ▶ Hardened clamping element has both a smooth surface for machined workpieces and a serrated clamping surface for rougher work
- ▶ Improved locking mechanism secures clamp to machine table
- ▶ Packaged individually (52224) or as kit of two (52424)

Part Number	Cam Screw	T-Slot Size	B	C	D	E	F	G	H	I	Max. Torque/Holding Force (Ft Lb/Lbs)	Replacement Square Washer
INCH												
52224	50372	5/8	5/16	.100	1.00	.375	.610	1.12	1.89	1.1	65/4,000	51016
METRIC DIMENSIONS												
		16	8	2	25.4	9.5	16	28.5	48	28	88.00/17800	

Torque mounting bolt to 70 Ft/Lbs (150N.m.).

